

FUSE SWITCH - DISCONNECTOR
SICHERUNGS - LASTTRENNSCHALTER
ПРЕДОХРАНИТЕЛЬНЫЙ ОТКЛЮЧАТЕЛЬ
POISTKOVÝ ODPÍNAČ
POJISTKOVÝ ODPÍNAČ

FH3-1

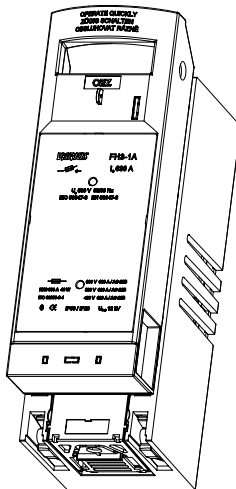

Installation, service and maintenance of the electrical equipment may be carried out by an authorized person only. Den Einbau, die Bedienung und Instandhaltung kann nur der Arbeiter mit der entsprechenden elektrotechnischen Qualifikation verrichten.

Монтаж, обслуживание и уход может производить только работник с соответствующей электротехнической квалификацией.

Montáž, obsluhu a údržbu môže vykonávať iba osoba s odpovedajúcou elektrotechnickou kvalifikáciou.

Montáž, obsluhu a údržbu smí provádět jen osoba s odpovídající elektrotechnickou kvalifikací.

FH3-1.

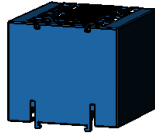

OD-FH3-KP1

OD-FH123-VU



CS-FH123-1Z



CS-FH3-1P2



CS-FH3-1P1

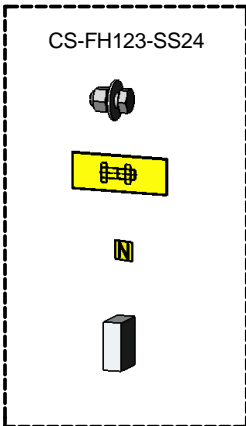

CS-FH123-SS24

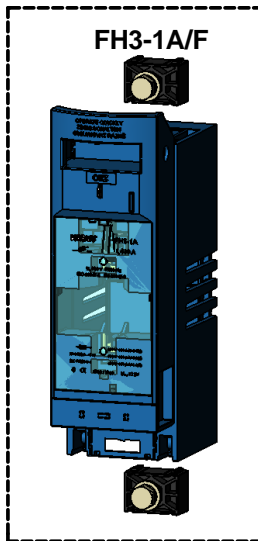

FH3-1A/F

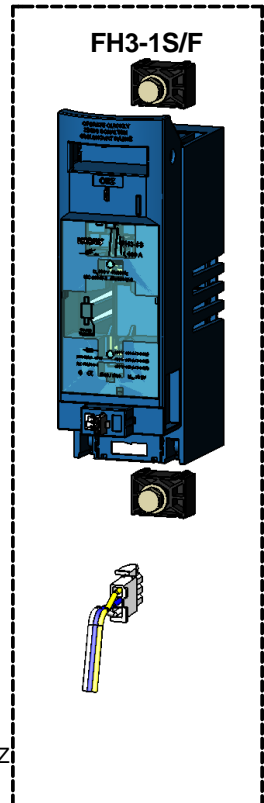

FH3-1S/F

OD-FH-SK



CS-FH3-1P1



CS-FH3-1P2



CS-FH123-1Z

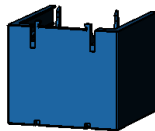

OD-FH3-KP1

FH3-1.

COVER TAKING OFF
DECKEL ABHEBUNG
СНЯТИЕ КРЫШКИ
ODNATIE VÍKA
SEJMUTÍ VÍKA

As for the FH3-1S version, the signalling connector has to be drawn out at first.
Bei der Ausführung FH3-1S muss zuerst der Konnektor der Signalisierung herausgezogen werden.
У версии FH3-1S необходимо сначала вынуть коннектор сигнализации.
U prevedenia FH3-1S najprv vytiahnuť konektor signalizácie.
U provedení FH3-1S nejdříve vytáhnout konektor signalizace

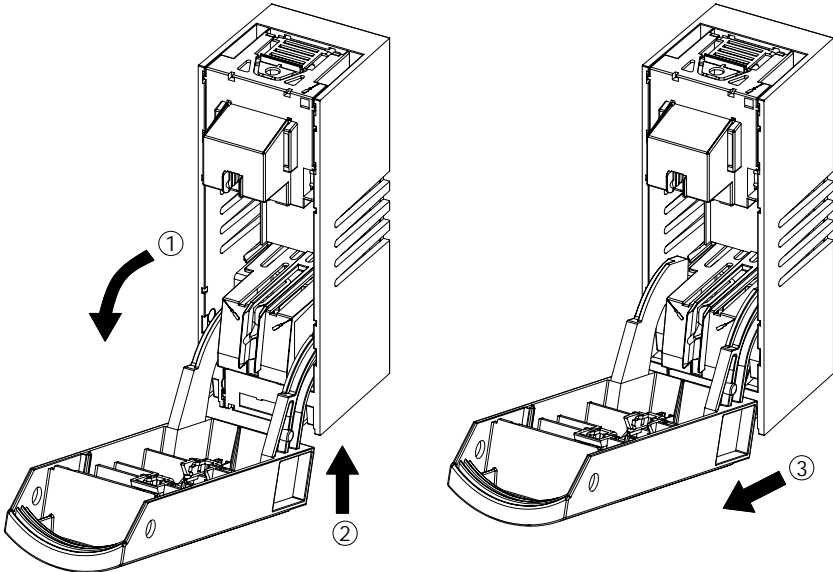

FUSE-LINK INSERTING
EINLEGEN DER SICHERUNG
ВЛОЖЕНИЕ ПРЕДОХРАНИТЕЛЯ
VLOŽENIE POJISTKY
VLOŽENÍ POJISTKY

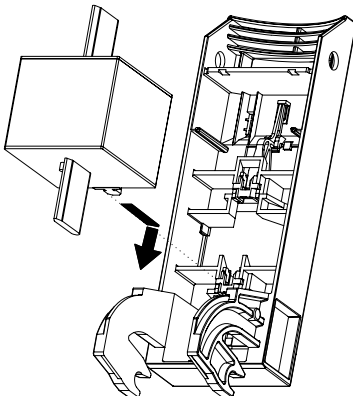

FUSE-LINK UNBLOCKING
ENTBLOCKIERUNG DER SICHERUNG
РАЗЪЕДИНЕНИЕ ПРЕДОХРАНИТЕЛЯ
UVOLNENIE POJISTKY
UVOLNĚNÍ POJISTKY

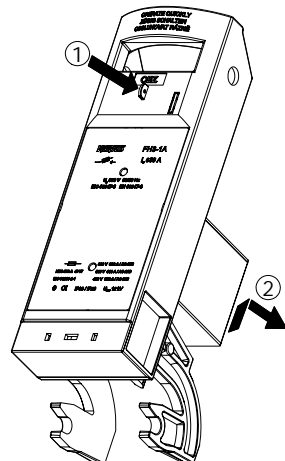

FH3-1.

DISMANTLING OF COVERS
ABHEBUNG DER ABDECKUNGEN
СНЯТИЕ КРЫШЕК
ODNATIE KRYTU
SEJMUTI KRYTU

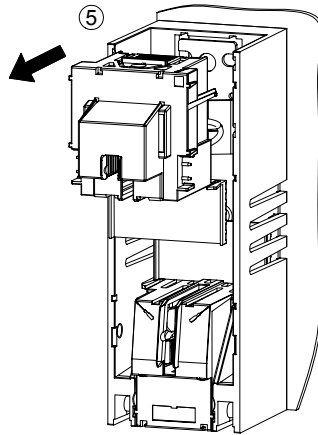
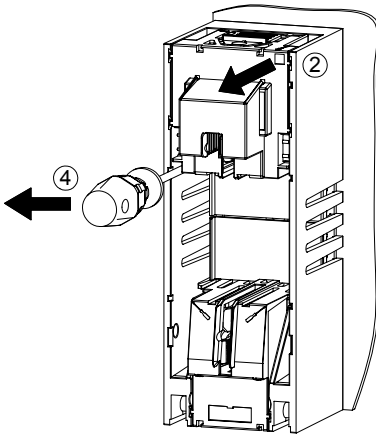
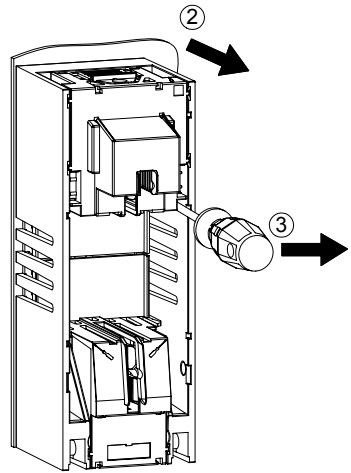
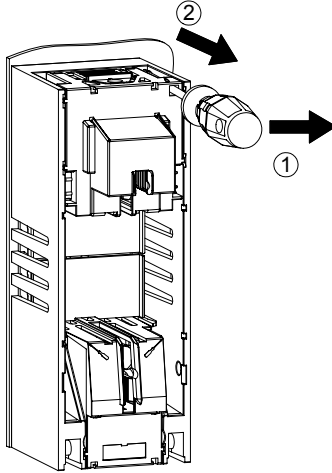
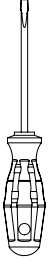

FH3-1.

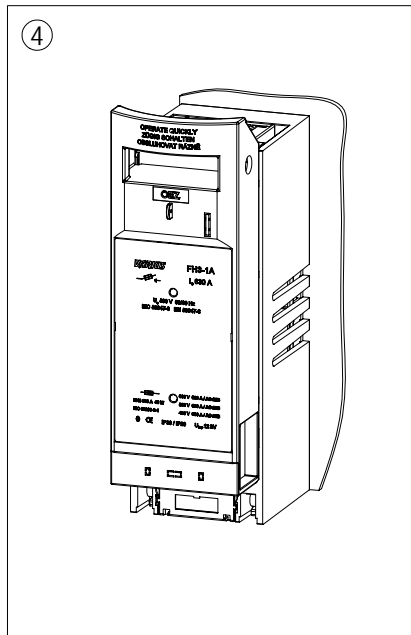
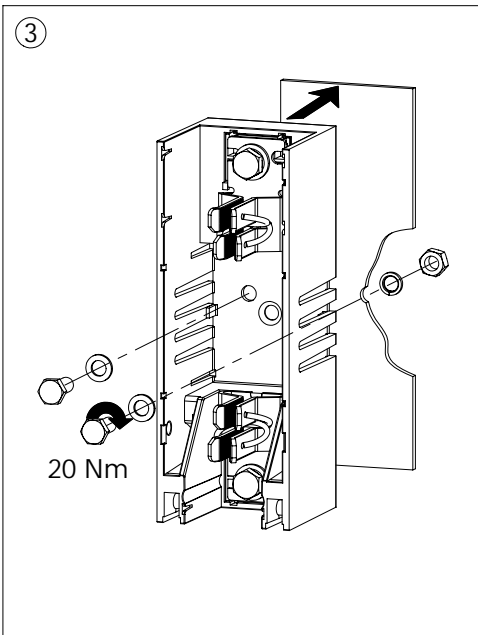
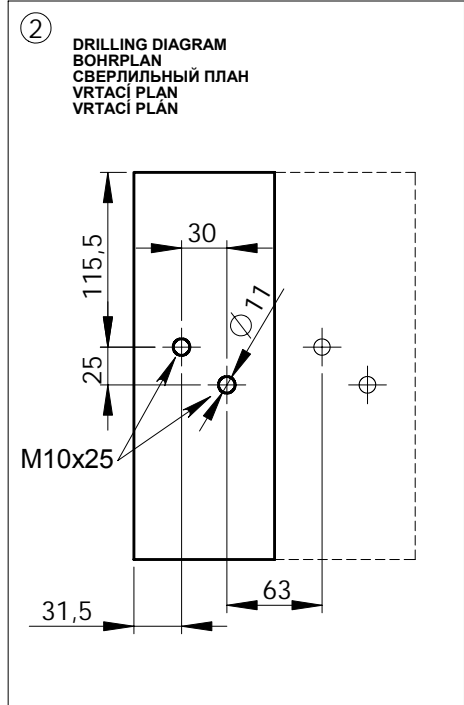
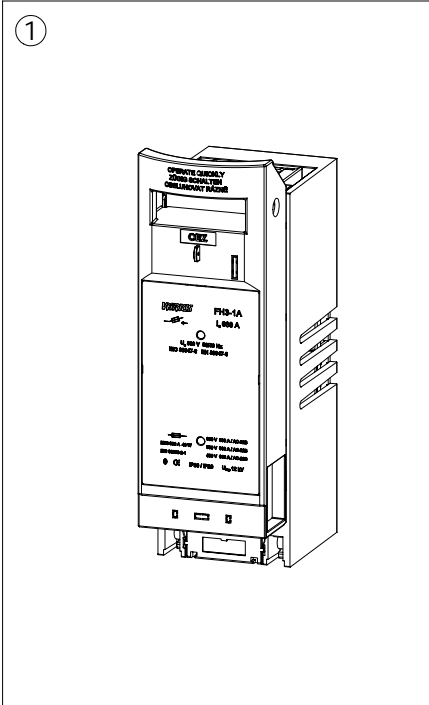

FH3-1.

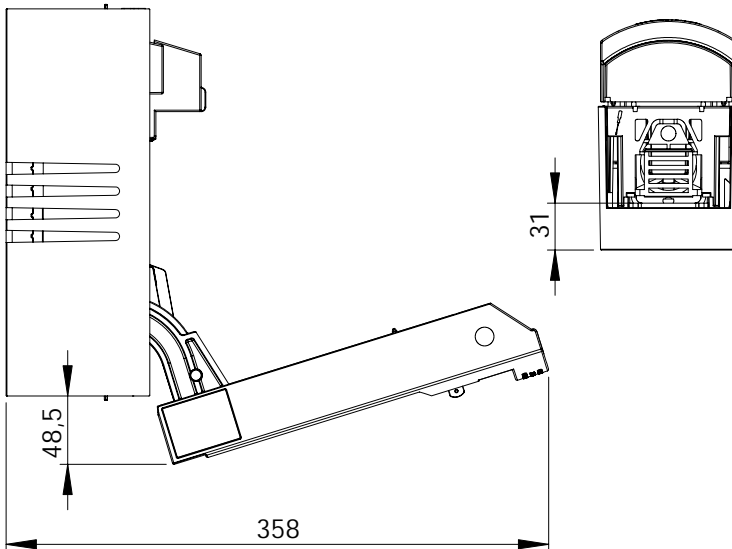
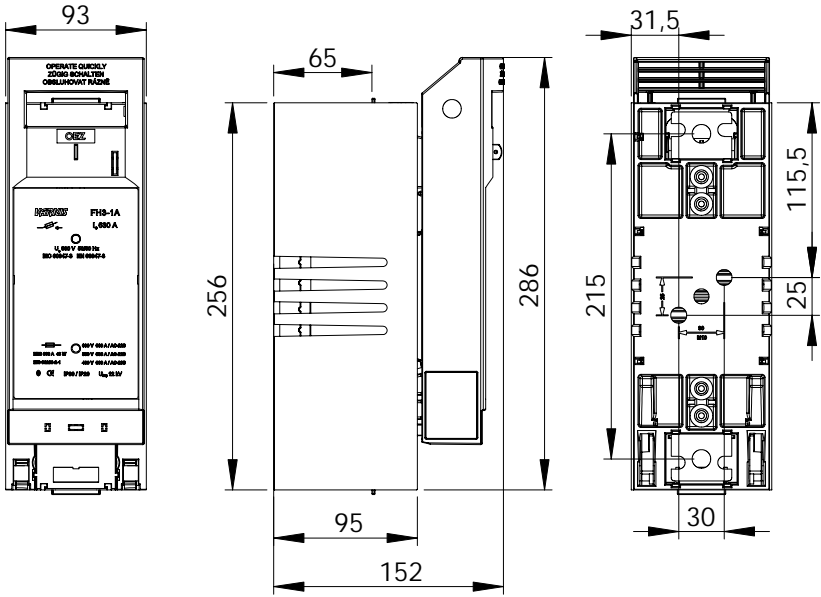

FH3-1S

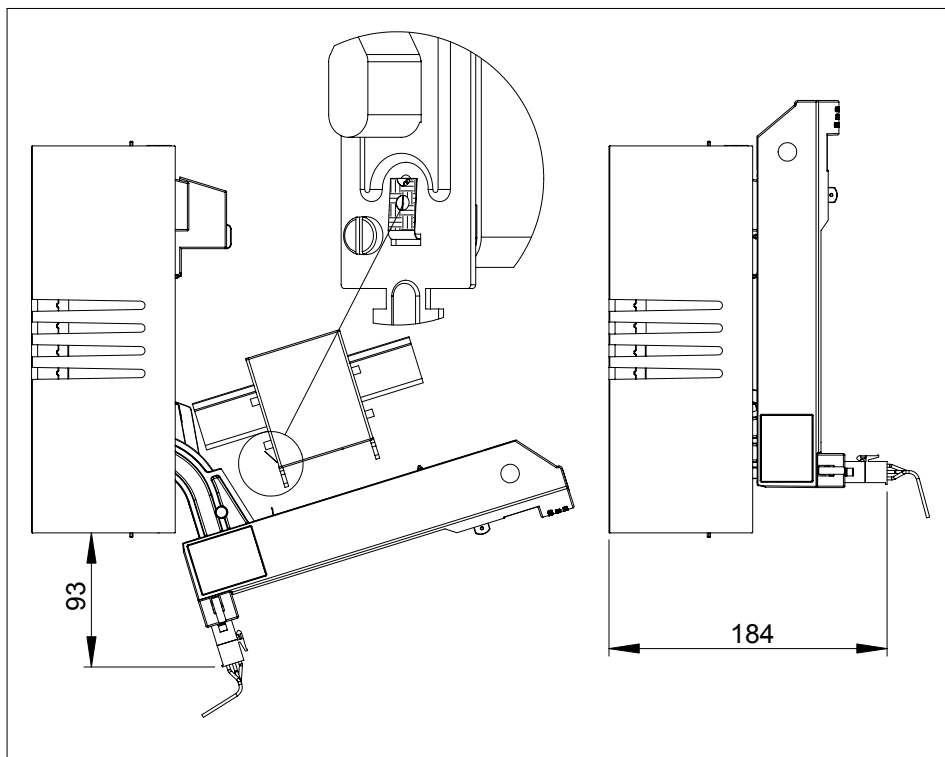
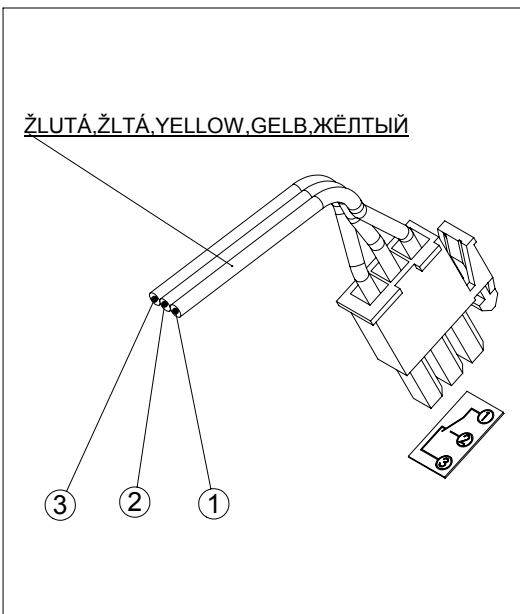
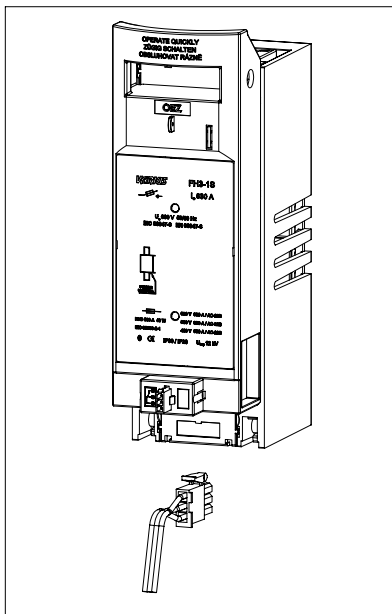

FH3-1/F

OD-FH3-KP1

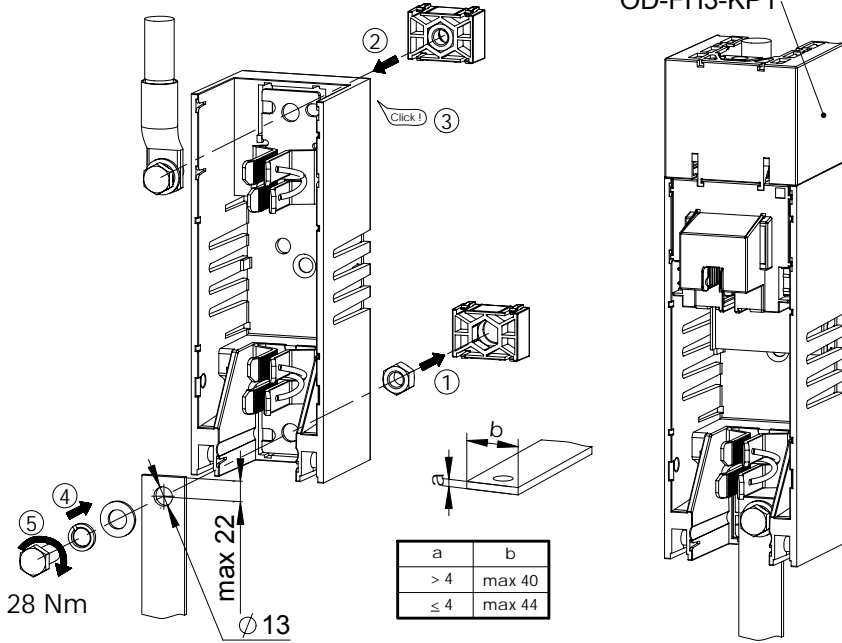

CS-FH3-1P1

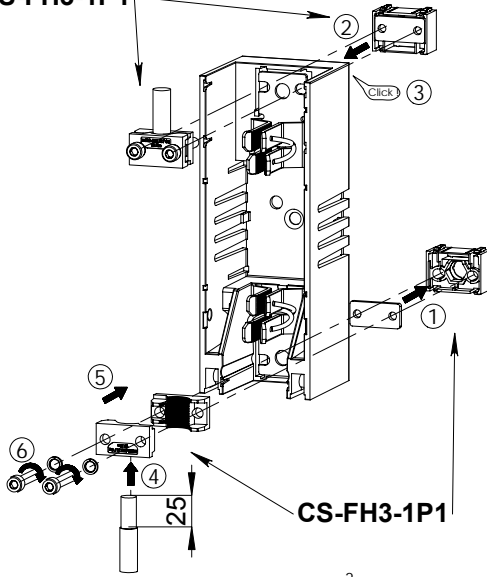

120 - 300 mm² Al,Cu ... 10 Nm

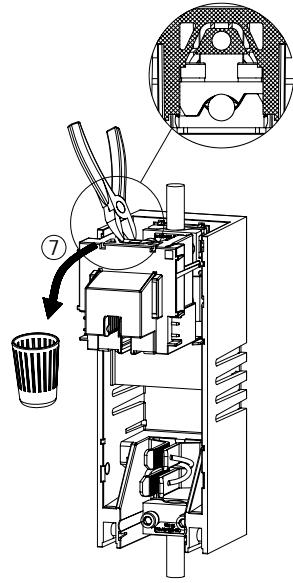

CS-FH3-1P2

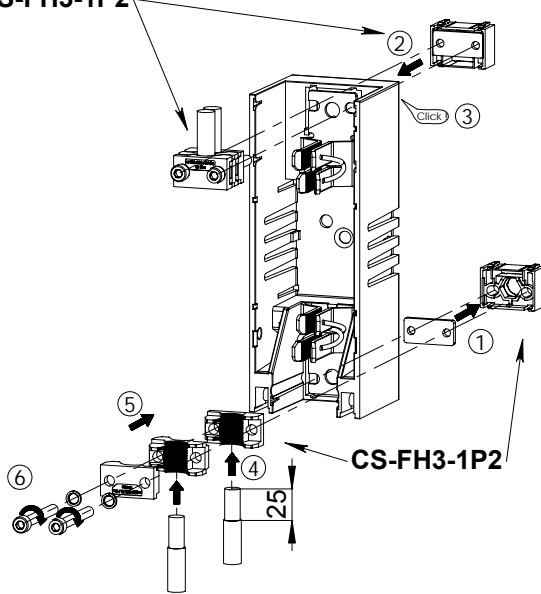

2 x 120 - 240 mm² Al,Cu ... 10 Nm

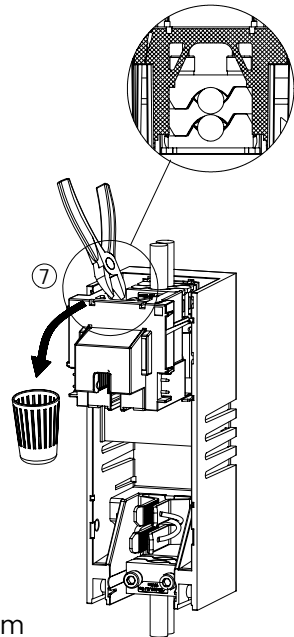

CS-FH123-3Z

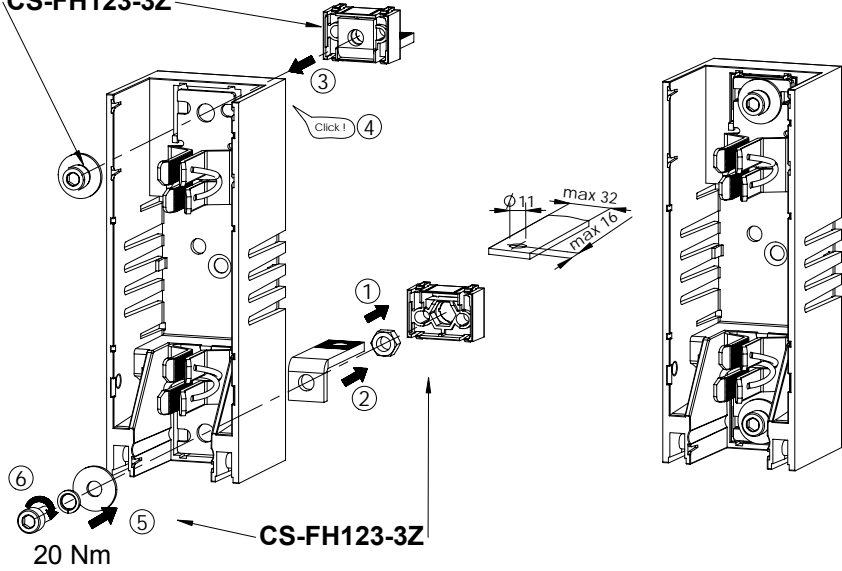

20 Nm

CS-FH123-3Z

DRILLING DIAGRAM
BOHRPLAN
СВЕРЛИЛЬНЫЙ ПЛАН
VRTACÍ PLAN
VRTACÍ PLAN

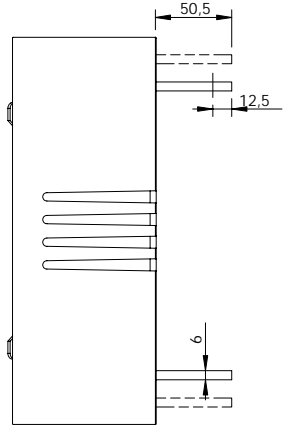
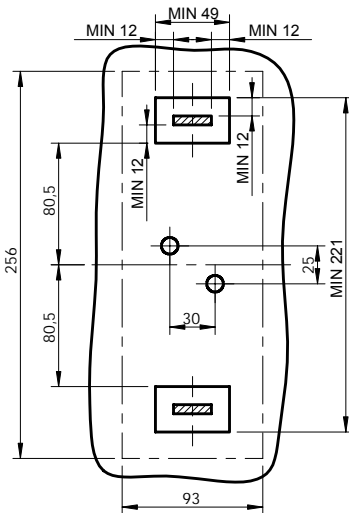

It is possible to dismantle, recycle the product or to store it at the secured depot after the end of its durability.
Das Produkt kann man nach der Lebensdauerbeendigung demontieren, recyceln, eventuell auf den gesicherten Ablageplatz lagern.

Изделие возможно после окончания срока службы демонтировать, переработать или сдать на охраняемую свалку.

Výrobok sa môže po ukončení životnosti demontovať, recyklovať, prípadne uložiť na zabezpečenú skládku.

Výrobek je možno po ukončení životnosti demontovat, recyklovat, případně uložit na zabezpečenou skládku.